

F-L-SC1508-0.3W

Electrical and Acoustical Parameter

Input Power(W)	0.3
Max. Input Power(W)	0.5
Impedance(Ω)	8 \pm 15%
Sound Pressure Level (dBA) @ 0.1m/0.5W/ 0, 1.6, 2.0, 3.2 kHz average	86 +/-3
Resonance Frequency F0(Hz)	850 \pm 20%
Frequency Range (Hz)	f0~20K
Remark:	n.a.

Mechanical, Environmental Parameter

Contact / Wire	Pad
Operating Temperature ($^{\circ}$ C)	-30 to +85
Storage Temperature ($^{\circ}$ C)	-40 to +85
Material Magnet	SMCO
Material Membrane	Kapton
Material Housing	LCP
Color Housing	Black
Component Weight (g)	1.5
Packaging	n.a.
Remark:	

Approval

RoHs	<input checked="" type="checkbox"/>
UL	<input type="checkbox"/>

Designed by	MZ	28.04.2014	Dimensions without tolerance \pm 0.5mm	Index: 00	Current date
Released by	CB	28.04.2014	Drawing number	140428.1LSO	28.04.2014
Changed by					Page 1 of 5

F-L-SC1508-0.3W



Drawing of Component

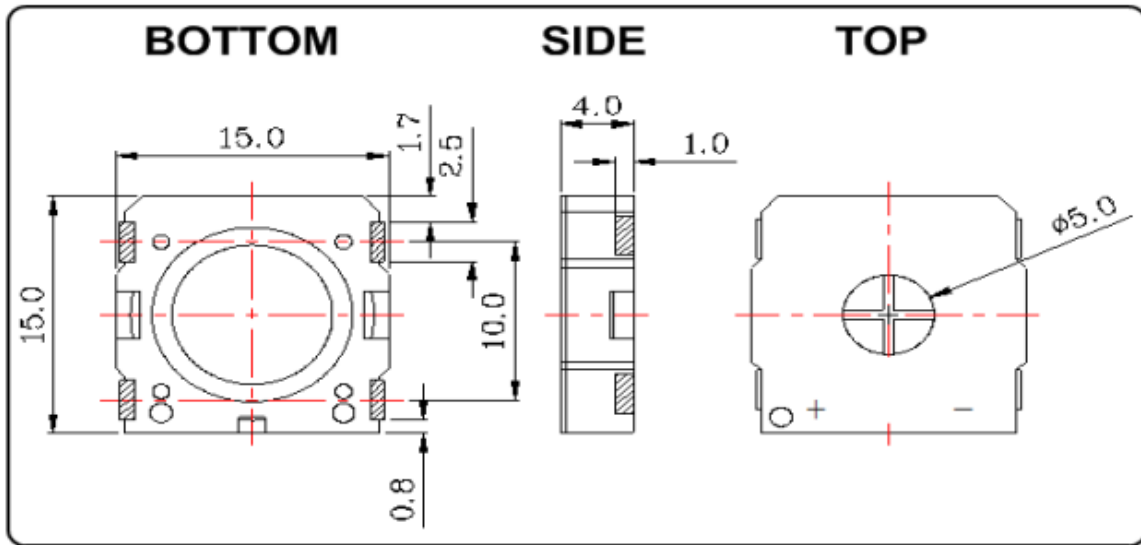

Frequency Response

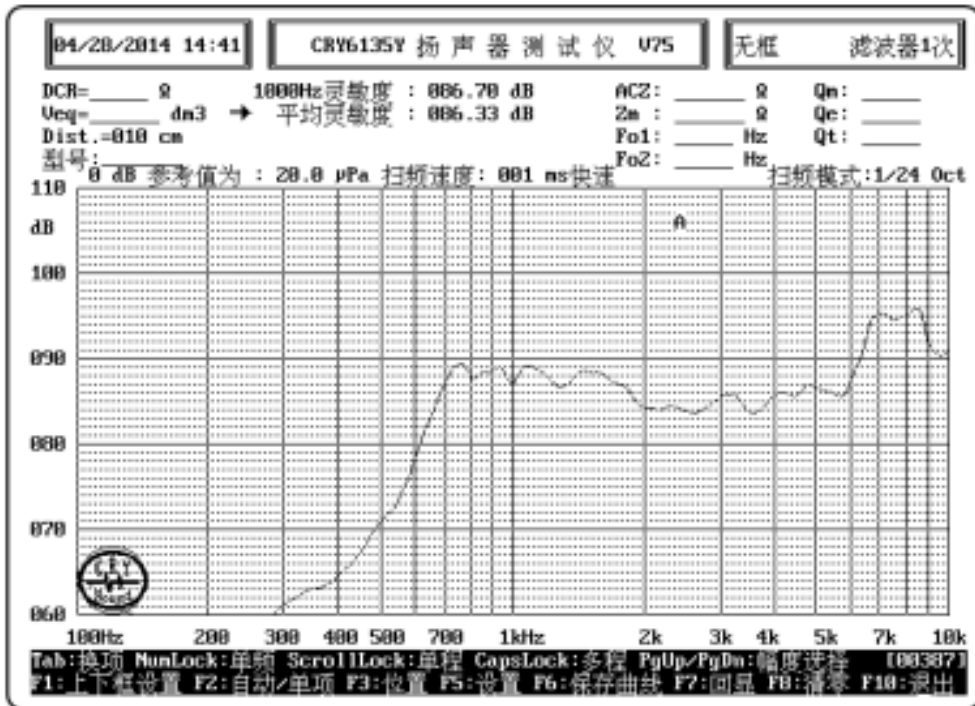

Designed by	MZ	28.04.2014	Dimensions without tolerance $\pm 0.5\text{mm}$	Index: 00	Current date
Released by	CB	28.04.2014	Drawing number	140428.1LSO	28.04.2014
Changed by					Page 2 of 5

F-L-SC1508-0.3W

Measuring Conditions

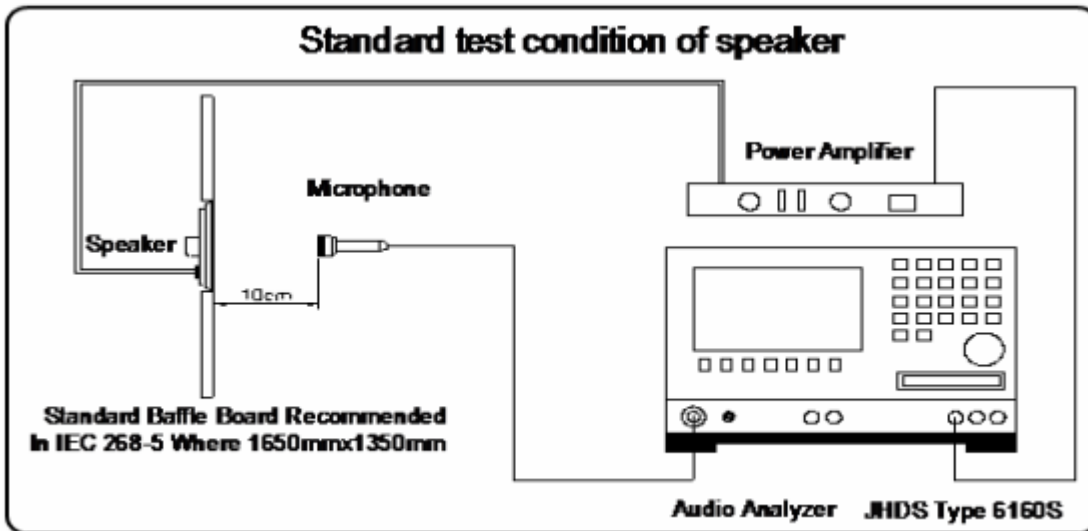
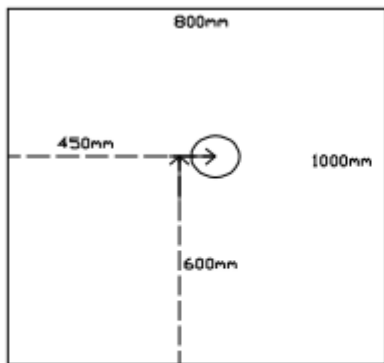

Designed by	MZ	28.04.2014	Dimensions without tolerance $\pm 0.5\text{mm}$	Index: 00	Current date
Released by	CB	28.04.2014	Drawing number	140428.1LSO	28.04.2014
Changed by					Page 3 of 5

F-L-SC1508-0.3W

Reliability Test

(Criteria : After these test , the change of S.P.L shall be within ± 3 dB)

1) Load Test

Rated Power White noise is applied for 96 hours

2) Temperature Test

Keep 96 hours at $+85^{\circ}\text{C} \pm 3^{\circ}\text{C}$ and leave 3 hours in normal temperature and then check

Keep 96 hours at $-40^{\circ}\text{C} \pm 3^{\circ}\text{C}$ and leave 3 hours in normal temperature and then check

3) Humidity Test

Keep 96 hours at $+40^{\circ}\text{C} \pm 3^{\circ}\text{C}$ relative humidity 92-95% and leave 3 hours in normal temperature and then checked.

4) Temp./Humidity Cycle Test

The part shall be subjected 5 cycles. One cycle shall be 12 hours and consist of;

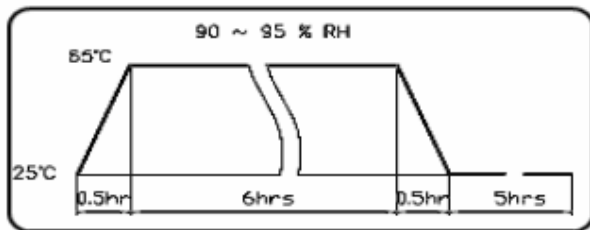

5) Thermal cycle test.

Low temperature: $-40^{\circ}\text{C} \pm 3^{\circ}\text{C}$, temperature: $+85^{\circ}\text{C} \pm 3^{\circ}\text{C}$, cycle:

1 hour/cycle each, and then keep 5 cycles in a room.

6) Vibration Test

10~55~10Hz sin-wave sweep 15min. 5G(constant)

X,Y, Z 3 direction. 2 hours each, total 6 hours.

7) Drop Test

Free drop from 100cm height to the concrete floor X,Y, Z 6 direction. 1 times each, total 6 times.

Recommended Land Pattern

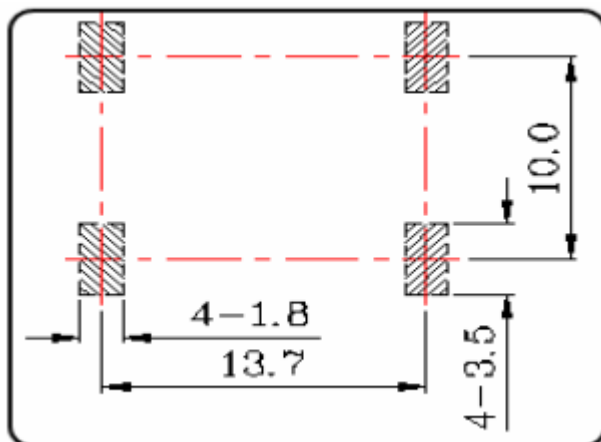

Designed by	MZ	28.04.2014	Dimensions without tolerance $\pm 0.5\text{mm}$	Index: 00	Current date
Released by	CB	28.04.2014	Drawing number	28.04.2014	
Changed by			140428.1LSO		Page 4 of 5

Packaging Information

n.a.

Revision Table

Index Nr.	Date Reason - Procedure Change description	Drawing Date	implementation	Comments
			LS-Nr.: Date	

Designed by	MZ	28.04.2014	Dimensions without tolerance $\pm 0.5\text{mm}$	Index: 00	Current date
Released by	CB	28.04.2014	Drawing number 140428.1LSO		28.04.2014
Changed by					Page 5 of 5